



TRADITIONAL WALL PACK LIGHT 30W
MODEL # GBTWP01



SYSTEM WATTAGE	30W
LUMENS	3300
EFFICIENCY	110 LM/W
DIMMING	0-10V
INPUT VOLTAGE	120-277V
REPLACES	
DIMENSIONS	10.62"L x 7.59"W x 6.61H
PF	>0.9
OPERATING TEMPERATURE	-20°C to 45°C
CRI	>80
COLOR TEMPERATURE	50K



DESCRIPTION & FEATURES

• Die-cast aluminum body(Bronze/Black). • The Wall Pack luminaires have a housing that is perfect fit for replacing existing traditional luminaires or as new installations for illuminating building exteriors, outdoor corridors, walkways, and stairwells. • Samsung LEDs • No IP issue • Glass refractor(lens). • Heavy duty die-cast aluminum housing, fully sealed to be dirt and bug proof •Built in button photocell. • Optional emergency battery backup for all wattages • ETL, DLC Premium, FCC • 10 year warranty • Wet locations , IP65

MOUNTING & WIRING

Mount directly over a standard outlet box or for surface wiring via any of the 3 convenient 3/4inch threaded conduit entry hubs.

ACCESSORIES & REPLACEMENT PARTS

• Dark Sky • Wire Guard • Replacement Glass Lens

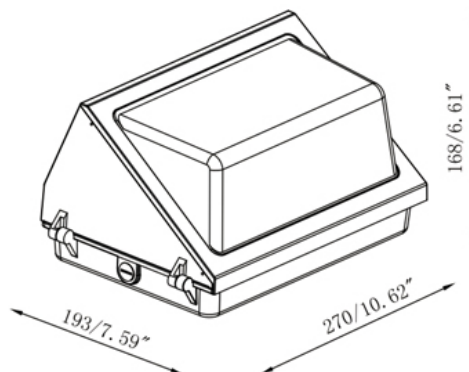



INSTALLATION MANUAL

MODEL # GBTWP01

Notes:

1. The Wall pack with Emergency backup driver, or Photocell, the Input voltage in AC120-277V only;
2. The 0-10V dimmable driver will be compatible for Leviton & Lutron Drivers.

READ ALL INSTRUCTIONS BEFORE INSTALLATION

1. Consult a qualified electrician to ensure correct branch circuit conductor.
2. The product should be installed and operated by a qualified electrician or technician in accordance with relevant local codes.
3. Risk of electric shock. Ensure that main power source is off when wiring or soldering the sections of the product.
4. Before installing this fixture or doing any maintenance, make sure to turn off the power supply at the circuit breaker or fuse box.
5. Check to make sure that all fixture connections have been properly made and the fixture is grounded to avoid potential electrical shocks.
6. Do not handle energized fixture when hands are wet, when standing on wet or damp surfaces, or in water.

IMPORTANT SAFETY INFORMATION



CAUTION: Risk of Electric Shock

INSTALLATION INSTRUCTIONS

1 : Junction box Mounting

1. Unscrew these two pieces screws on the right side by a suitable screwdriver, then take apart the male and female connectors, and then take off the reflector apart from the back plate.

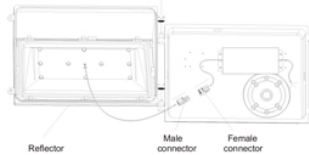

2. To get four holes in 5.0mm by knocking-out four points in A/B/C/D. And then unscrew the Bolt(1) on the central bottom. (Note: The Other three Bolt (2)/(3)/(4) can be unscrewed according to different requirement during wiring process.)

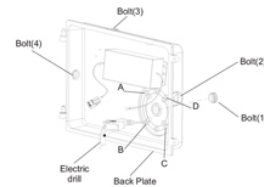

3. Put the main power from the water-proof J-box cross through the hole(H), and then lock the back plate and the water-proof J-box by four pieces #8-32 screws.

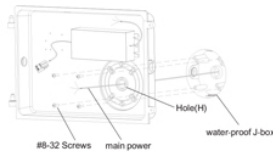

4. Hinge and Lock the reflector with the back plate firmly, and then connect the main power accordingly - the black wiring to L, White to N, Green to G, then connect the male and female connectors together, and finally, screw the reflector with the back plate by the suitable screwdriver.

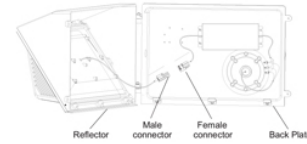

5. And then put the cutoff shade on the top of the wall pack, make sure the holes on the shade must be aligned with the frame's holes as well. (Ps: The Cutoff shade as accessory, not as standard.)

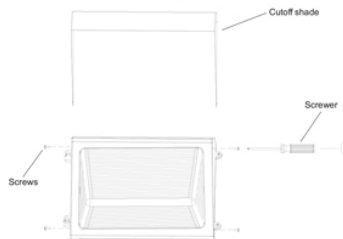

2 : Conduit Mounting

1. Unscrew these two pieces screws on the right side by a suitable screwdriver, then take apart the male and female connectors, and then take off the reflector apart from the back plate.

2. Unscrew the right-side bolt(5); And get three holes in 6.5mm - E/F/G by a suitable drill, then fasten the back plate to the wall by three pieces suitable Screw Components.

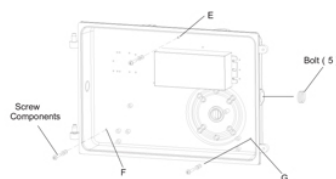

3. Put the main power through the right hole and then finish the wiring (Black wire - L, White wire - N, Green wire - G)

4. Hinge and Lock the reflector to the back plate firmly, and connect the male and female connectors together, and then, screw the reflector with the back plate by the suitable screwdriver.

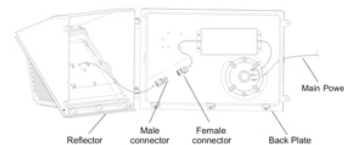

TIPS:

If the Wall pack with inside emergency driver available, then adopt the 2nd installation instruction - Conduit Mounting.